

Designed for safety. Built for fun.

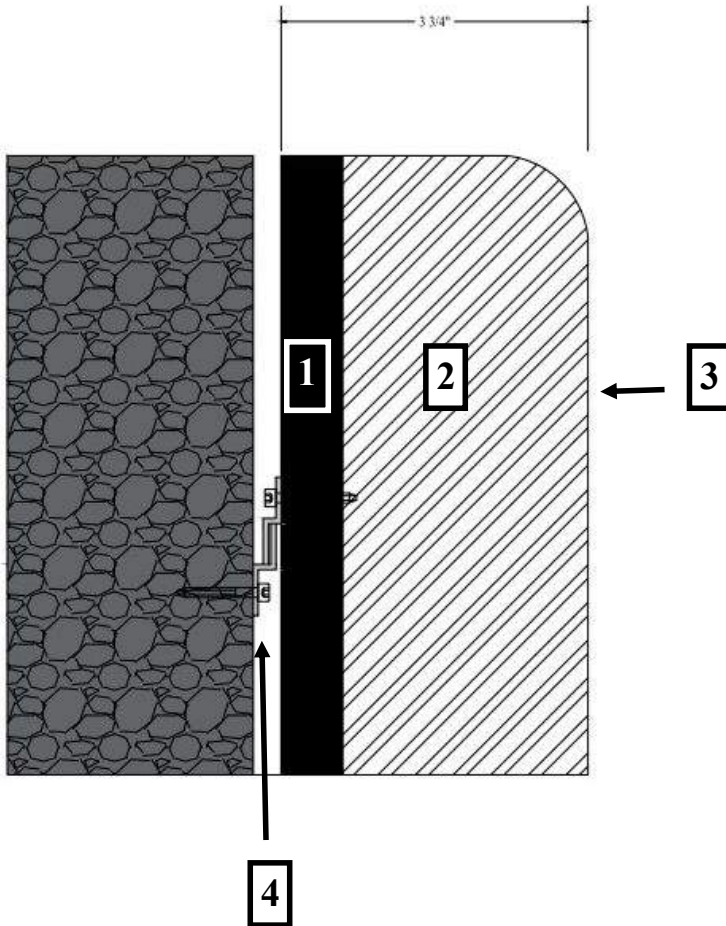

#1

3/4" Severe Weather AWP compliant Treated Pine Plywood Sheathing.

- Primed & Painted with extreme conditions exterior paint.

#2

3" High Impact Foam

- Density: 1.50 pcf o
- Impression Load: 25% 75-85, 65% 128-145 Support Factor 65/25 1.7 min
- Rebound %: 40-48%
- Tear Resistance: 1.5-2.5 lbs/in
- Static Fatigue: <35% % loss @ 25% ILD

#3

Advantage MVP Vinyl

- 18.5 oz/sq yd
- 3000+ hour UV resistance
- Emboss: Course Matte
- Construction: 9 x 9, 1000 x 1000 Denier
- Tongue Tear: 100 x 100 lbs / 1"
- Grab Tensile: 375 x 375 lbs / 1"
- Adhesion: 26lbs /2"
- Meets CAL117-2013 Flammability Test
- Abrasion: 1000 cycles
- Rot, Mildew, & Fungus Resistant
- Available in 18 color choices

#4

1.5" Aluminum Z Clip

- Placed at bottom & top of pad and an additional z clip placed in middle for pads 8' in height.
- Attached with 1" Galvanized Screw



Designed for safety. Built for fun.

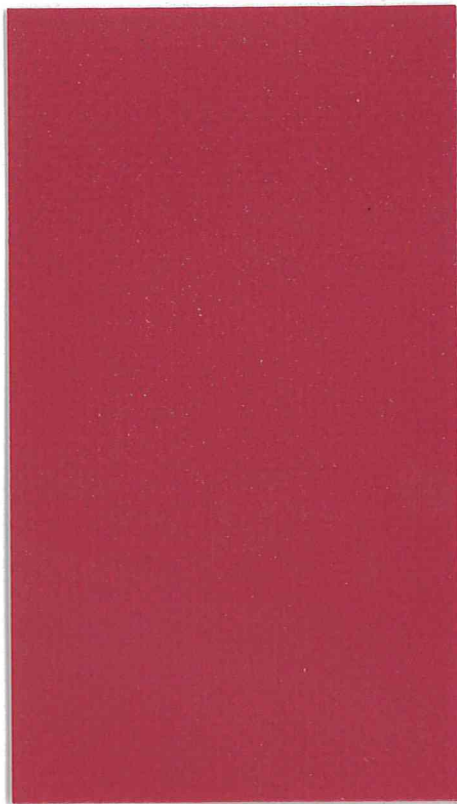

Scarlet Red



Black*

Navy*

True Blue



Regal Blue

Royal Blue*

Carolina Blue



Marine Blue

Forest Green

Green*



Lime Green

Purple

Maroon



Burgundy

Cardinal Red

Red*

Bright Pink

Brown*



Tan*

Orange*

Tangerine

Yellow*

Charcoal Grey*

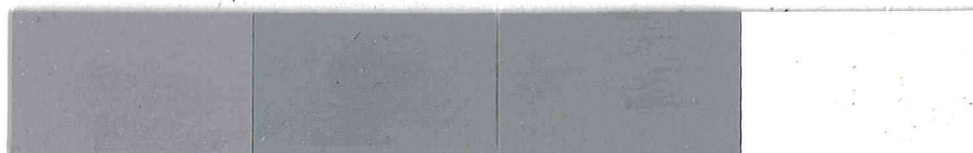

Grey*

Steel Grey

Light Grey

White*